



Jeff Kinder

Executive Vice President,
Design & Manufacturing

KURT

KURT Mfg. Co.
Manchester, NH
Precision Manufacturing
MODEL SERIAL NO.

Disruption in manufacturing



Momentum in D&M

Fusion

AI in D&M

Disruption in manufacturing



Momentum in D&M

Fusion

AI in D&M

Autodesk targeting mid-market manufacturers

With scalable design & make processes in the cloud

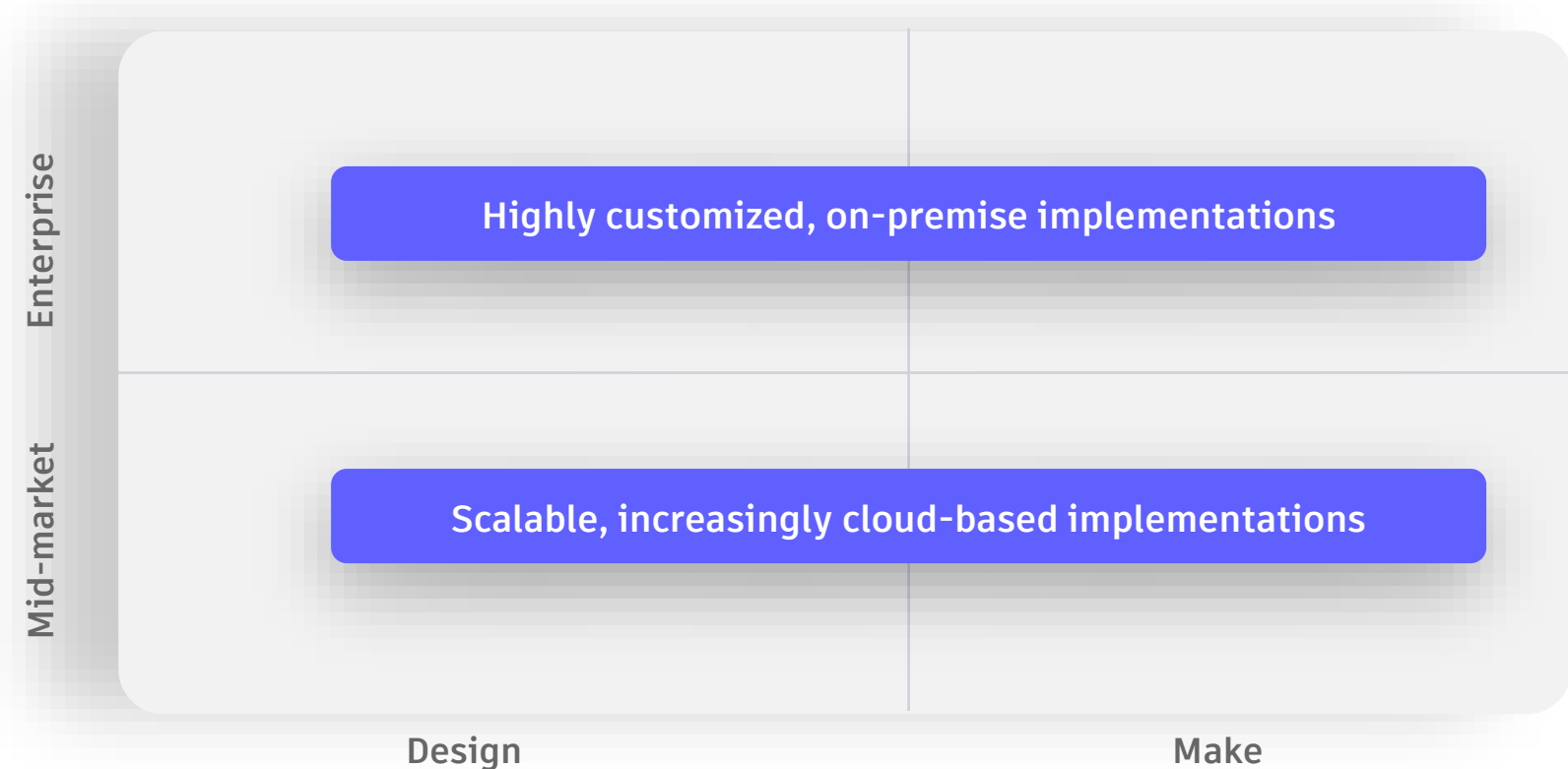

Our target is mid-market manufacturers

With scalable design & make processes in the cloud

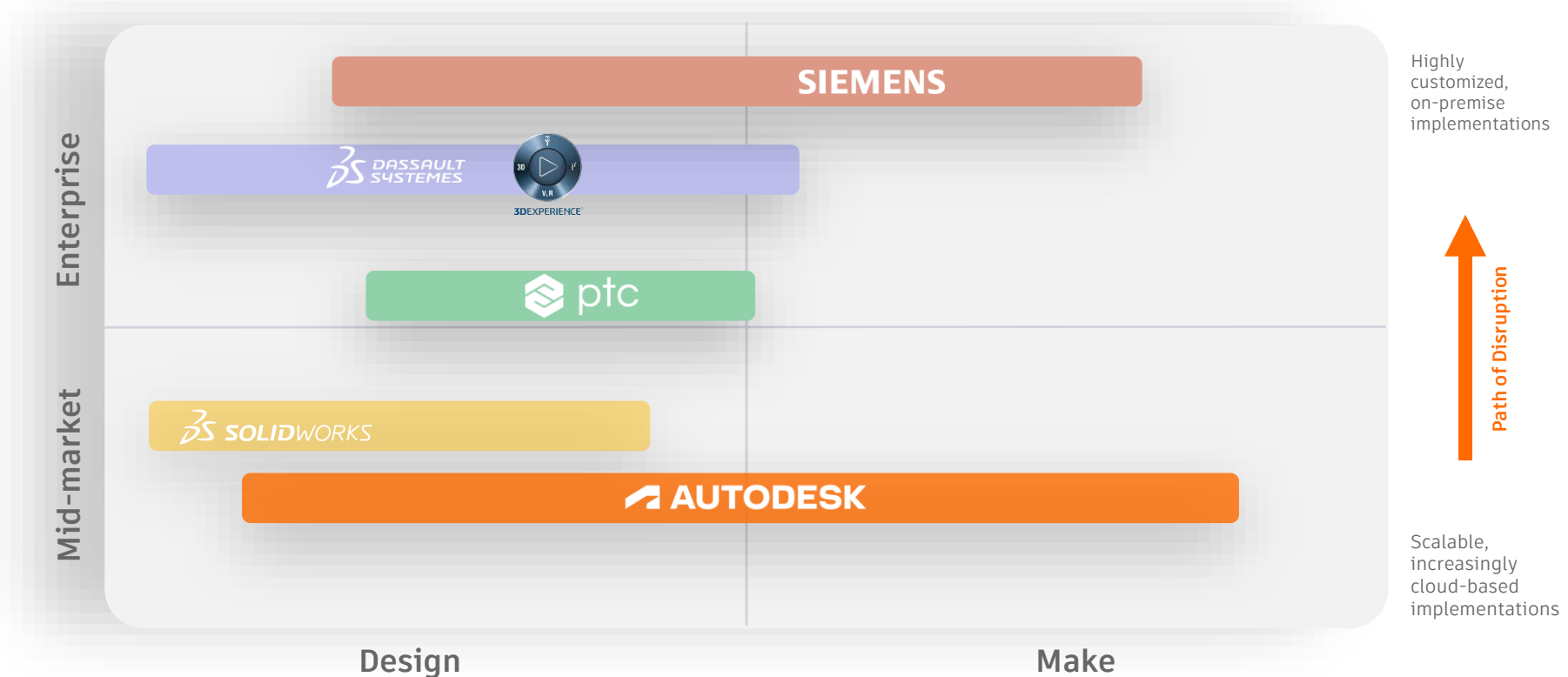

Intentional segmentation for Desktop & Fusion

Established segments with desktop products vs. emerging segments with Fusion

Desktop brands

Industrial Machinery

Core brands continue to grow in established segments

Products

Mobility & Transportation

A CAD I PRO V PRO A SRF

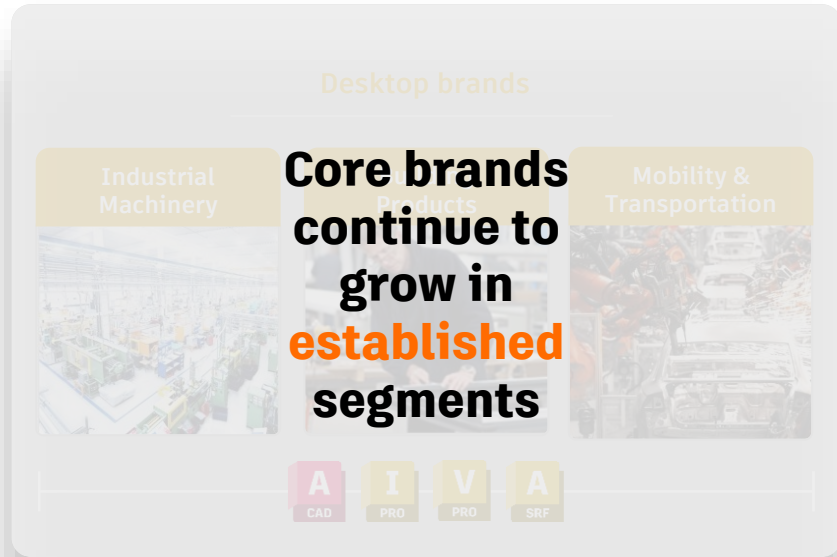
The diagram for Desktop brands is presented on a light gray rounded rectangle. At the top, the text 'Desktop brands' is written in a light orange font. Below this, there are three vertical panels. The left panel is titled 'Industrial Machinery' and shows a factory floor with various machines. The middle panel is titled 'Products' and contains the main text 'Core brands continue to grow in established segments' in bold black and orange fonts. The right panel is titled 'Mobility & Transportation' and shows a car engine and parts. At the bottom, there is a horizontal line with four colored boxes containing the letters 'A', 'I', 'V', and 'A', with the labels 'CAD', 'PRO', 'PRO', and 'SRF' underneath them respectively.

Fusion

Hobbyist

Fusion proving product-market fit in emerging segments

Machine

Consumer Products

F

The diagram for Fusion is presented on a light gray rounded rectangle. At the top, the text 'Fusion' is written in a light orange font. Below this, there are three vertical panels. The left panel is titled 'Hobbyist' and shows a 3D printer. The middle panel is titled 'Machine' and contains the main text 'Fusion proving product-market fit in emerging segments' in bold black and orange fonts. The right panel is titled 'Consumer Products' and shows a drone. At the bottom, there is a horizontal line with a single orange box containing the letter 'F' and a white arrow pointing to the right.

Fusion is rapidly maturing

Evolved from hobbyist tool to a professional-grade solution for SMB

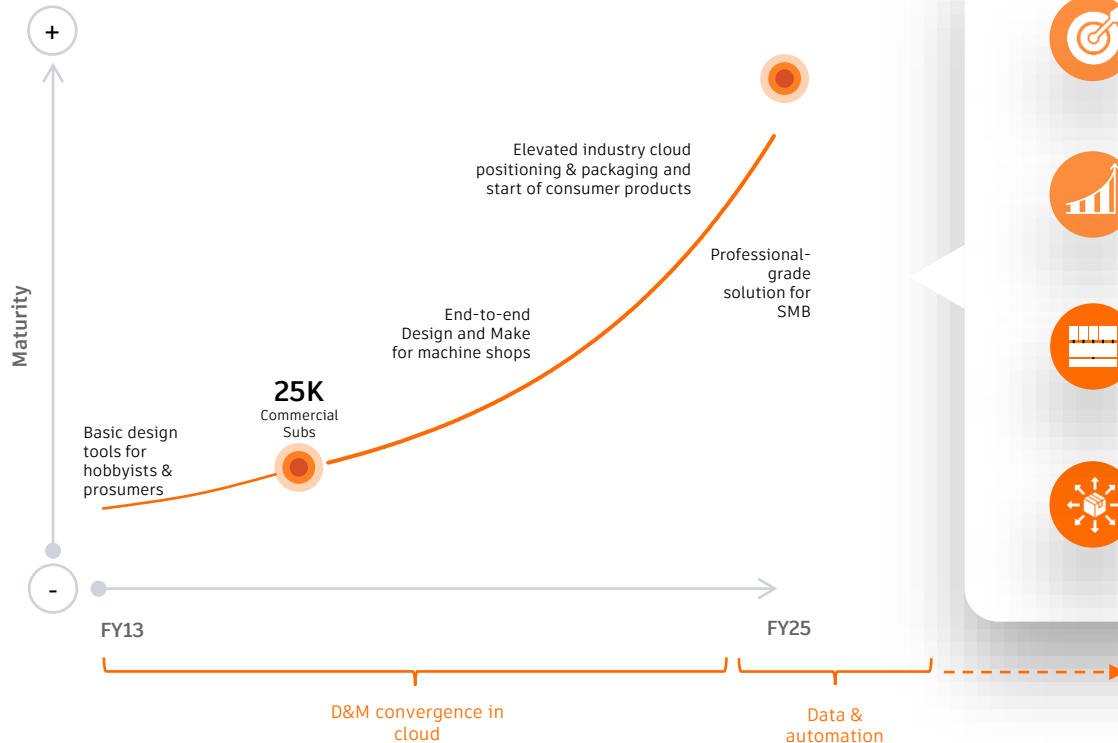

First product to pioneer cloud convergence

Convergence of design and manufacturing



Fastest growing CAD/CAM product

4 million users and counting



Rapid evolution to industry cloud

Elevated positioning, glidepath for pricing and packaging, and capabilities



Ongoing investment to expand up-market

Multi-sub accounts, new sectors, and new personas

Disruption in manufacturing



Momentum in D&M

Fusion

AI in D&M

Fusion price point is disruptive

\$5,000 – \$50,000



VS

\$680

Subscription
PER YEAR



Flexible offering increases price realization

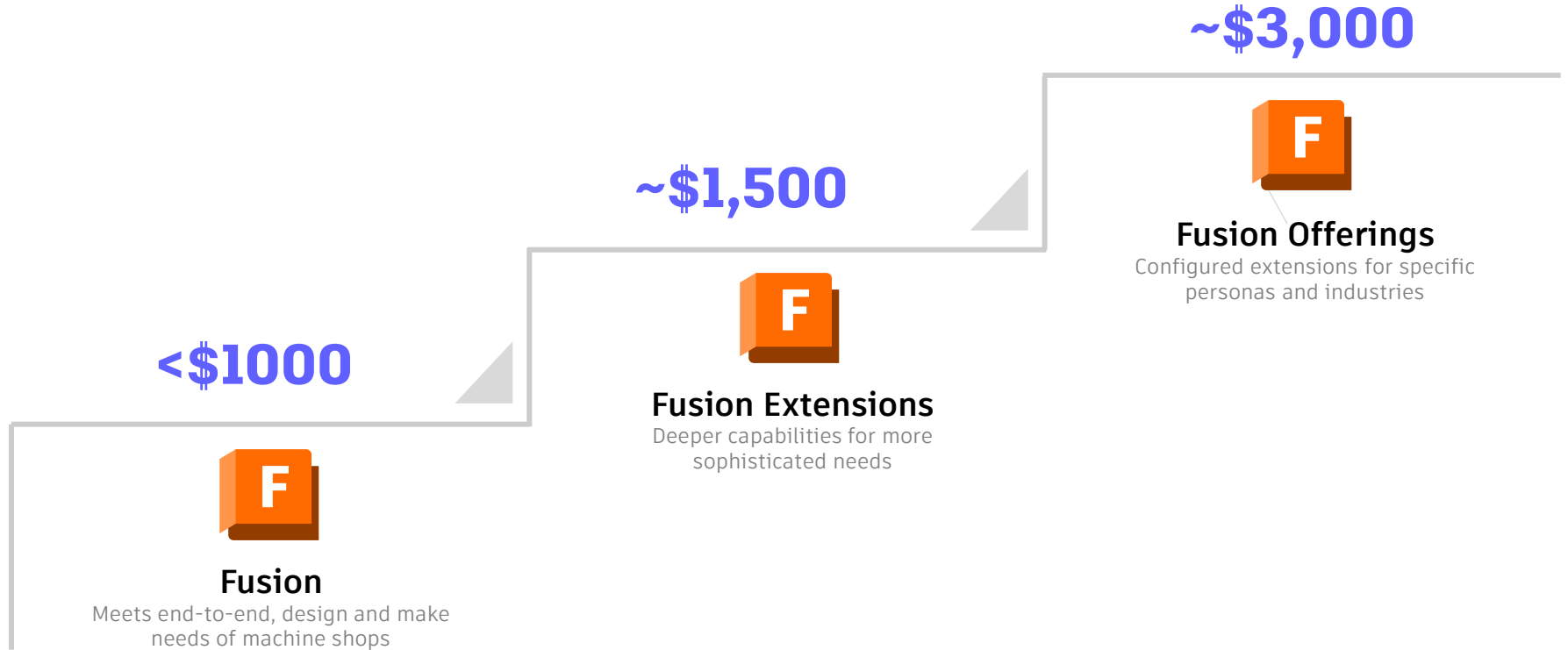

Building for large accounts



**Manufacturing
Data Model**



**Editable Bill
of Materials**



**Reducing
Latency**



**Admin
Capabilities**



Disruption in manufacturing

Momentum in D&M

Fusion

AI in D&M

Our approach to AI

AUTOMATE

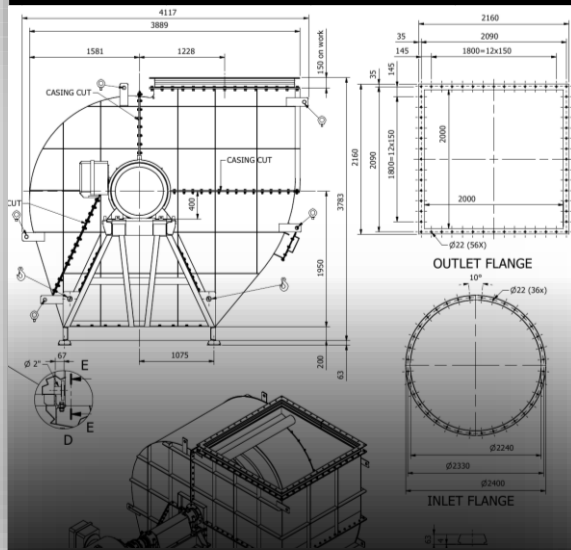

AUGMENT

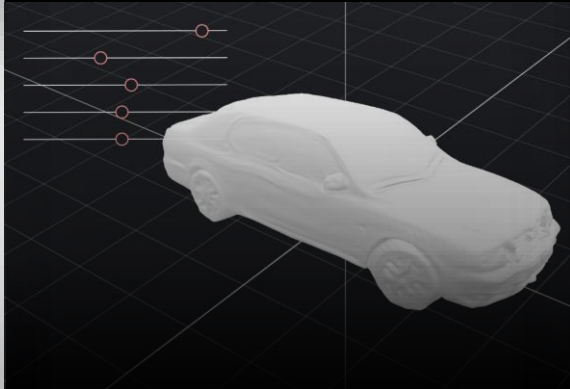

ANALYZE

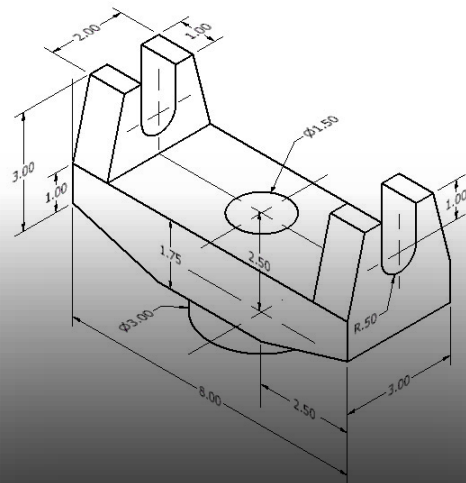

Drawing Automation

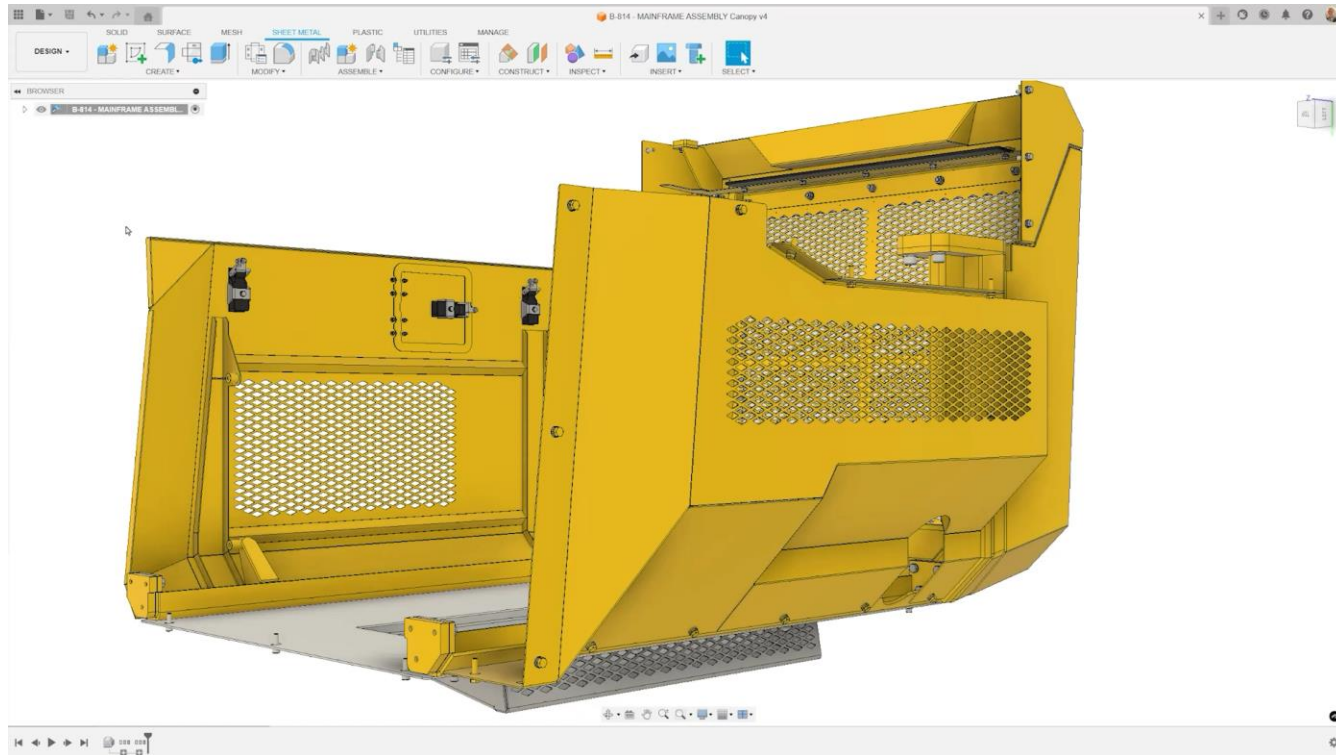

AutoConstrain

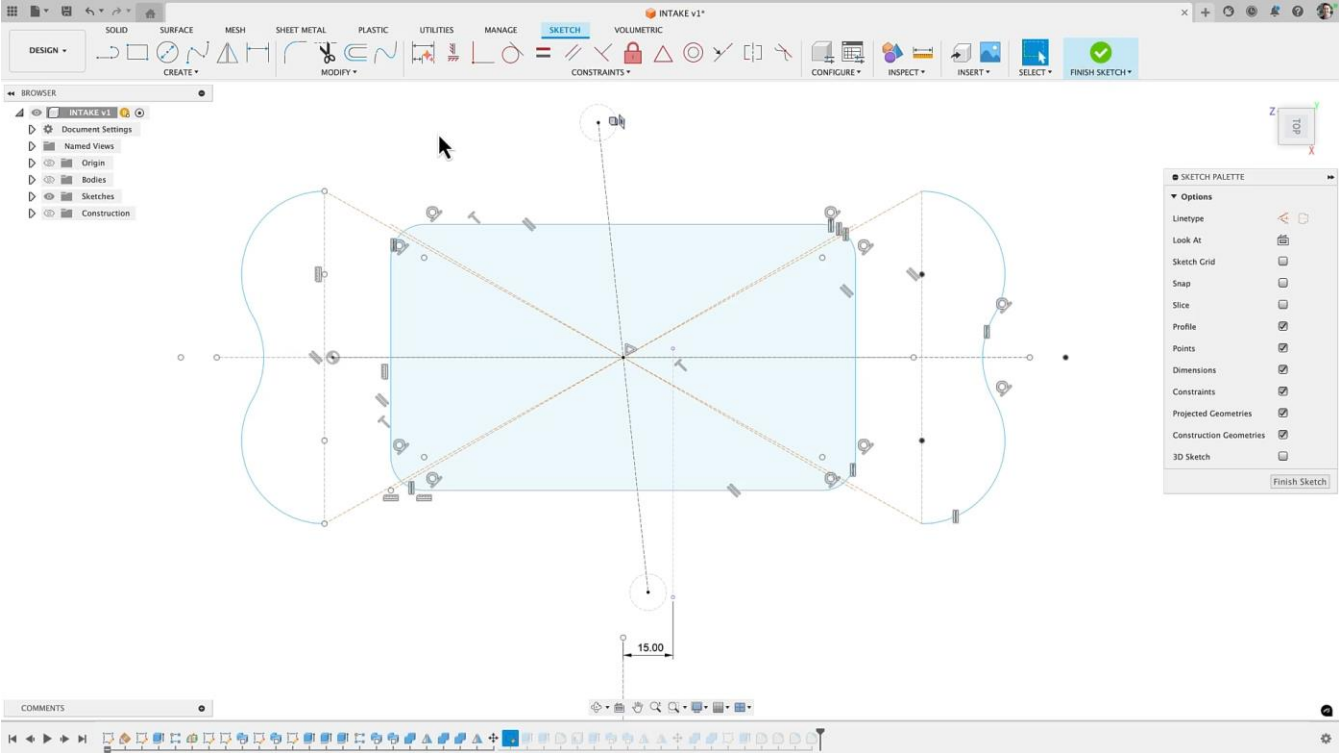

Autodesk Assistant

The image shows a screenshot of the Autodesk software interface. The main window displays a 3D model of a complex mechanical part, identified as "SMA 750 Motor v1 v6". The interface includes a top toolbar with various manufacturing tools categorized under MILLING, TURNING, ADDITIVE, INSPECTION, FABRICATION, and UTILITIES. A left sidebar shows a BROWSER panel with a tree view of the model's structure, including "Units in", "Named Views", "Origin", "Models", and "Setup".

Overlaid on the right side of the interface is a chat window titled "Autodesk Assistant". The chat window contains the following text:

The advisor is an AI tool here to assist you. For better accuracy in responses, you can ask related questions in the same chat session. Use a new chat for questions on a new topic. Remember to fact check any responses.

Below the introductory text are four suggested questions in button format:

- What is the difference between 2D and 3D toolpaths?
- Give me a list of toolpath that can machine flat areas
- How do I tilt my tool to avoid collisions?
- Where is the toolpath trimming command?

At the bottom of the chat window is a text input field with the placeholder text "Ask anything about manufacturing..." and a "Send" button. Below the input field is a "New Chat" button.

At the bottom of the software interface, there is a "COMMENTS" section and a row of system icons.

Project Bernini

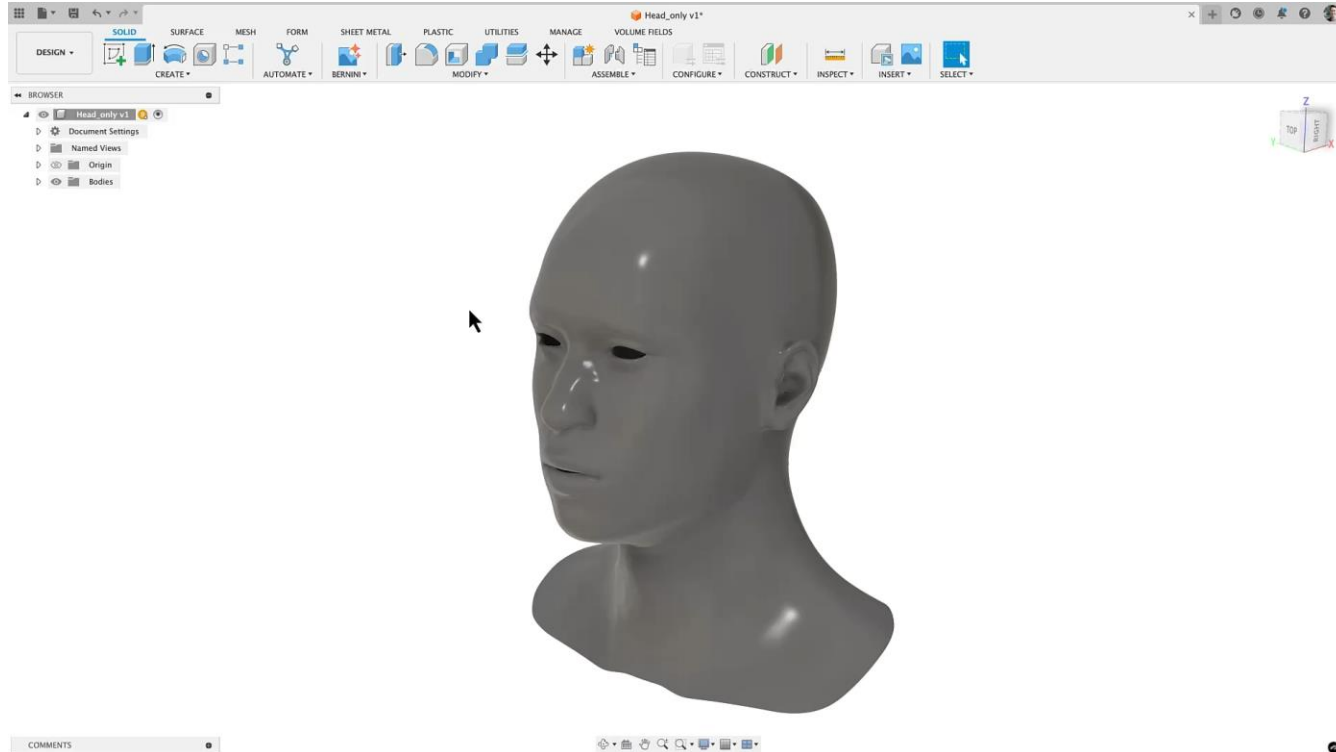

Why we win in D&M

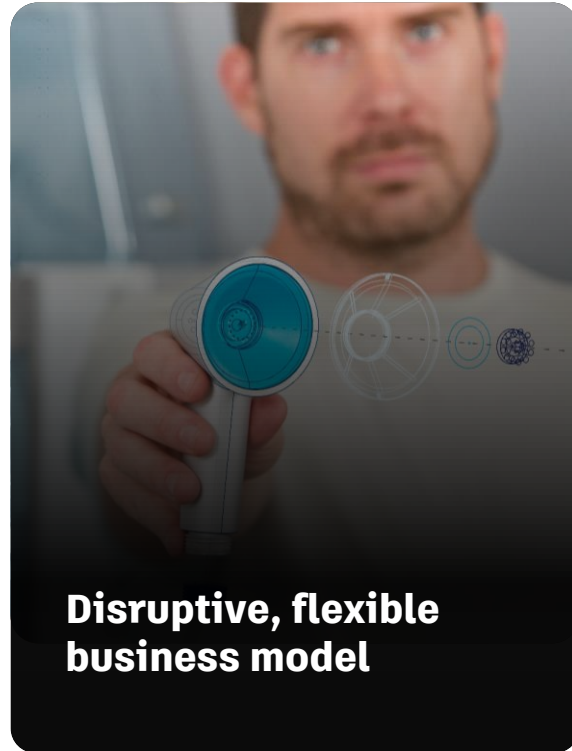
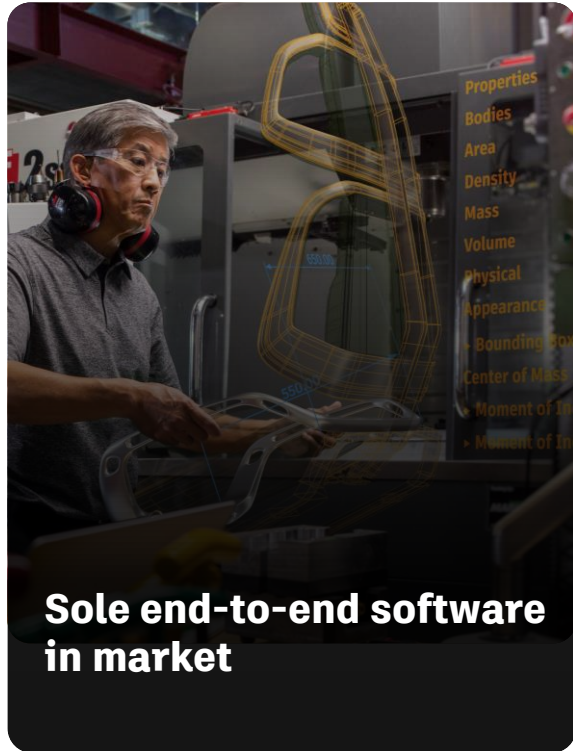



Make Anything