

Safe Harbor

Each of the presentations today will contain forward-looking statements about our strategies, products, future results, performance or achievements, financial, operational and otherwise, including statements about our strategic priorities, business model transition, and guidance for the first fiscal quarter and fiscal year 2019; our long term financial and operational goals; our M&A strategy; our capital allocation initiatives; and our stock repurchase program. These statements reflect management's current expectations, estimates and assumptions based on the information currently available to us. These forward-looking statements are not guarantees of future performance and involve significant risks, uncertainties and other factors that may cause our actual results, performance or achievements to be materially different from results, performance or achievements expressed or implied by the forward-looking statements contained in these presentations, such as a failure to maintain ARR, ARPS, subscriptions, billings, revenue, deferred revenue, operating margins and cash flow growth; difficulty in predicting those financial and performance metrics; failure to maintain spend management; failure to successfully manage transitions to new business models and markets, including our efforts to expand in construction and manufacturing, convert customers to subscription plans, and attract customers to our cloud-based offerings; failure to successfully expand adoption of our products; and negative developments in worldwide economic or political conditions.

A discussion of factors that may affect future results is contained in our most recent Form 10-K and Form 10-Q filings available at www.sec.gov, including descriptions of the risk factors that may impact us and the forward-looking statements made in these presentations. The forward-looking statements made in these presentations are being made as of the time and date of their live presentation. If these presentations are reviewed after the time and date of their live presentation, even if subsequently made available by us, on our website or otherwise, these presentations may not contain current or accurate information. We disclaim any obligation to update or revise any forward-looking statement based on new information, future events or otherwise.

Non-GAAP Financial Measures

These presentations include certain non-GAAP financial measures. Please see the section entitled "Reconciliation of GAAP Financial Measures to non-GAAP Financial Measures" in the Appendices attached to the presentations for an explanation of management's use of these measures and a reconciliation of the most directly comparable GAAP financial measures.

AUTODESK INVESTOR DAY

MARCH 28, 2018

Winning in Construction & Manufacturing

Scott Reese

SVP, Manufacturing, Construction & Production Products



Two Opportunities

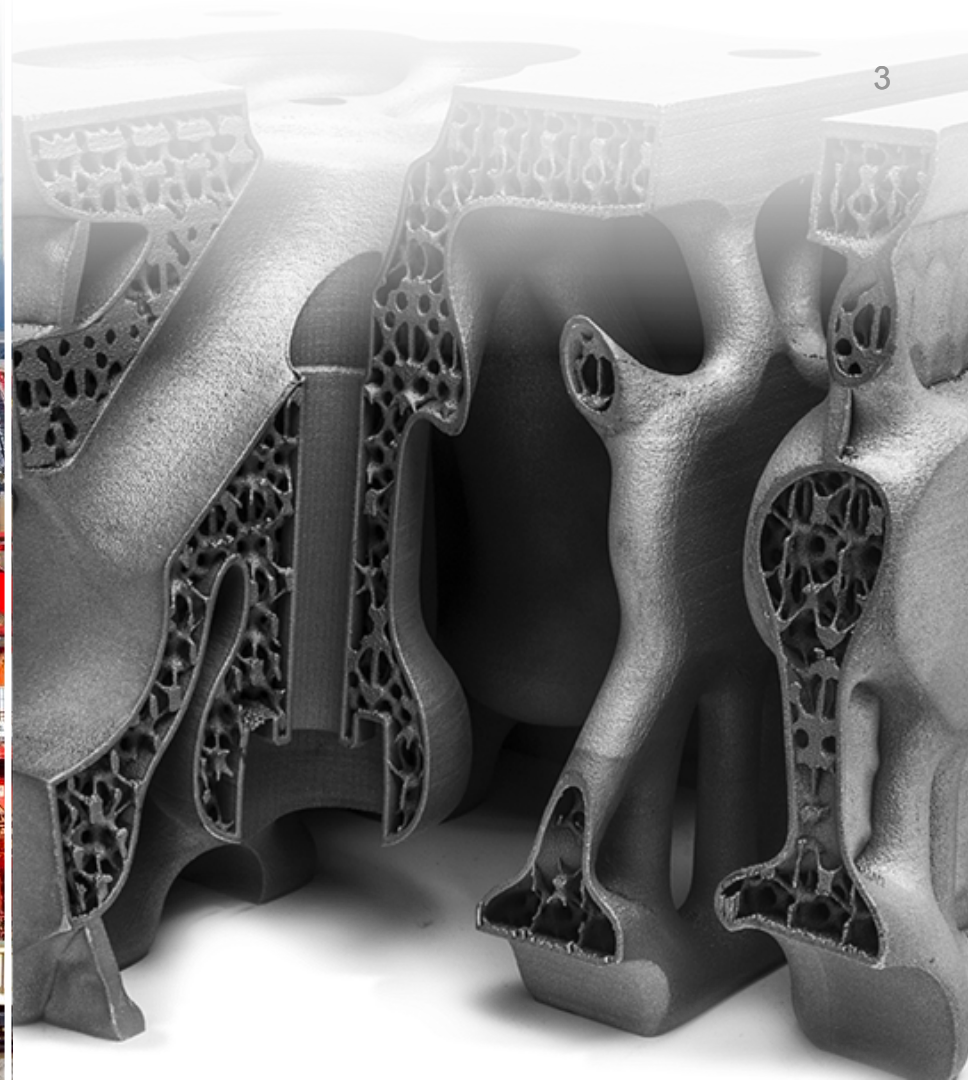

Construction



AEC PROCESS

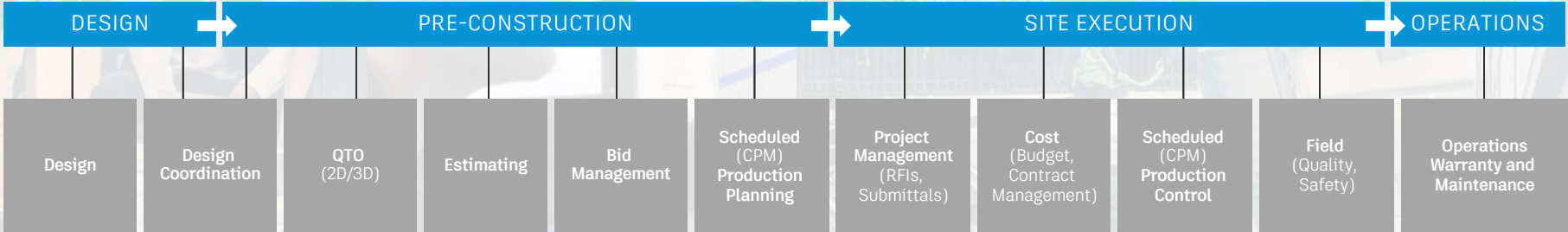

AEC PROCESS

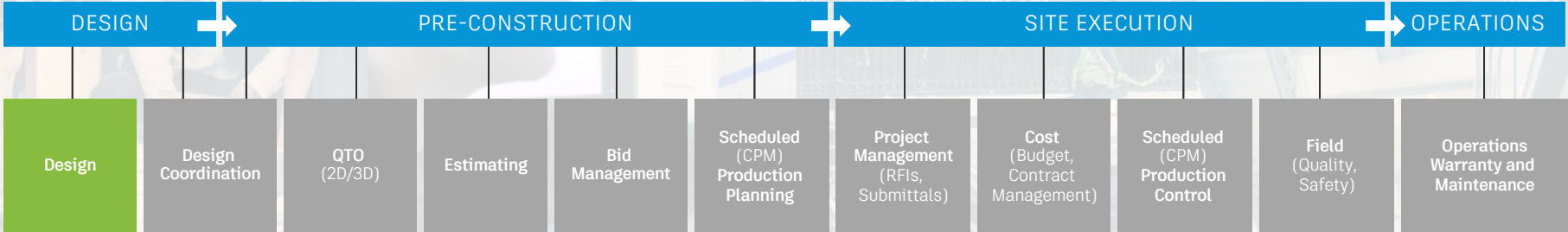

AEC PROCESS

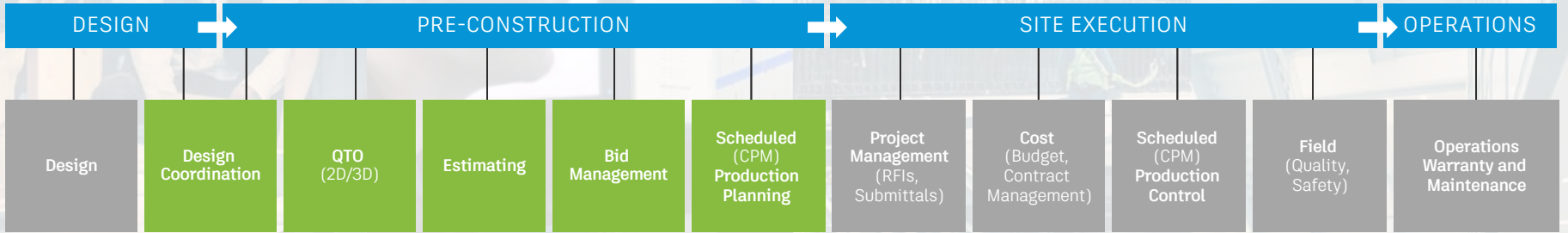

AEC PROCESS

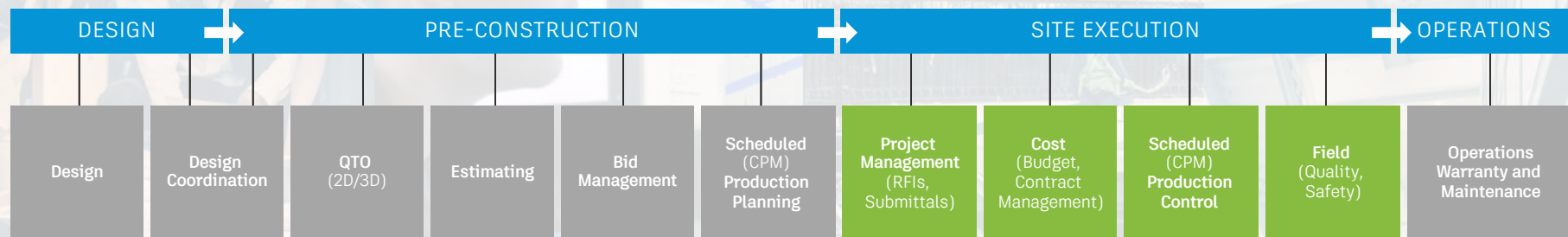

AEC PROCESS

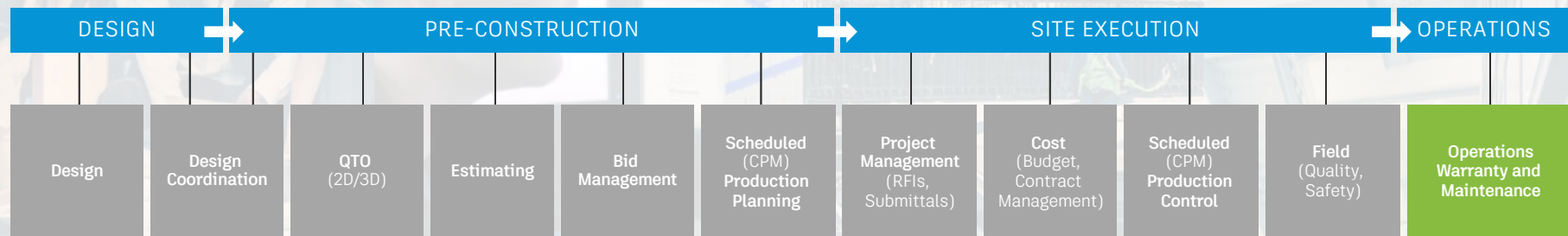

AEC PROCESS

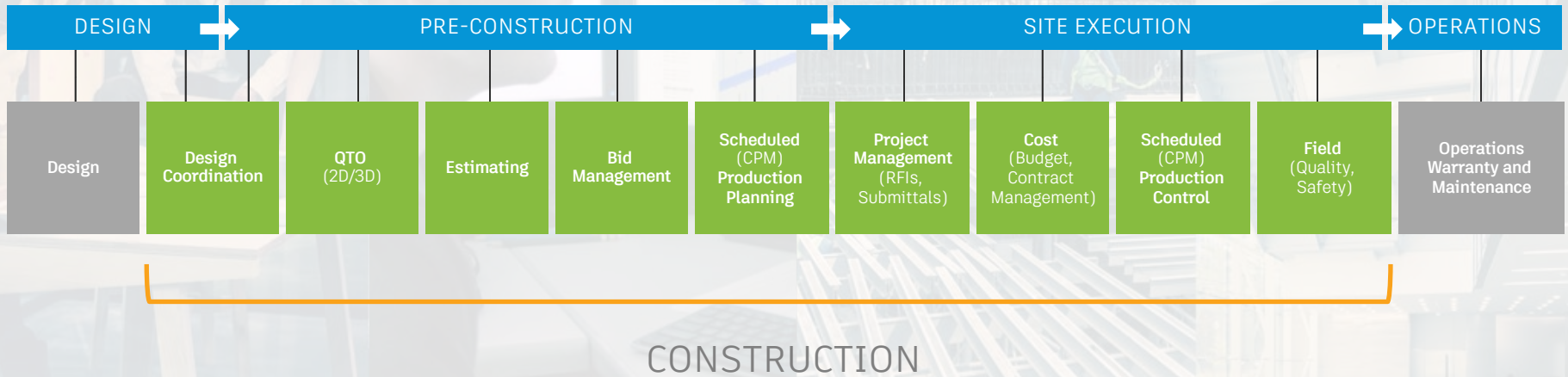

AEC PROCESS

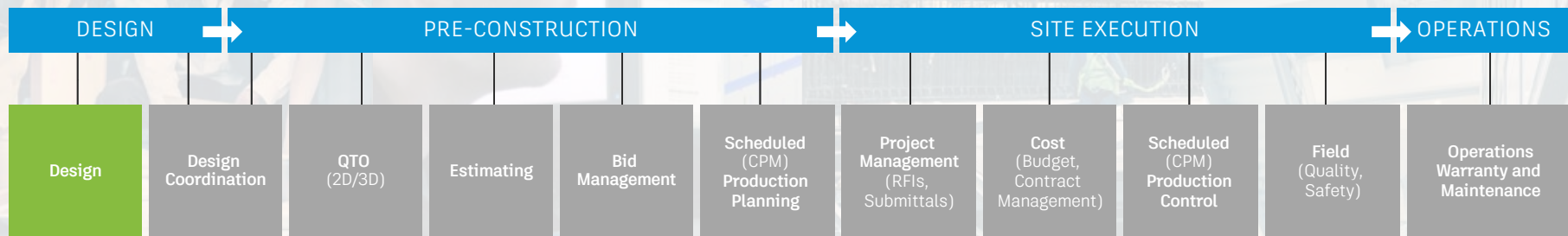

BIM DATA

AEC PROCESS

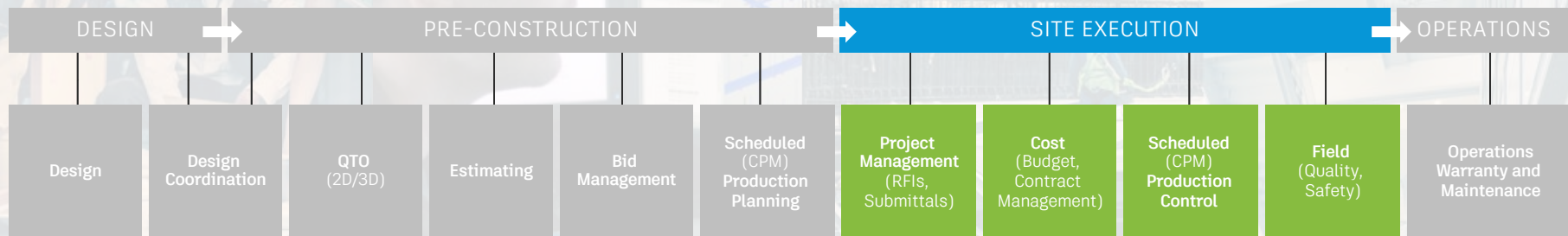

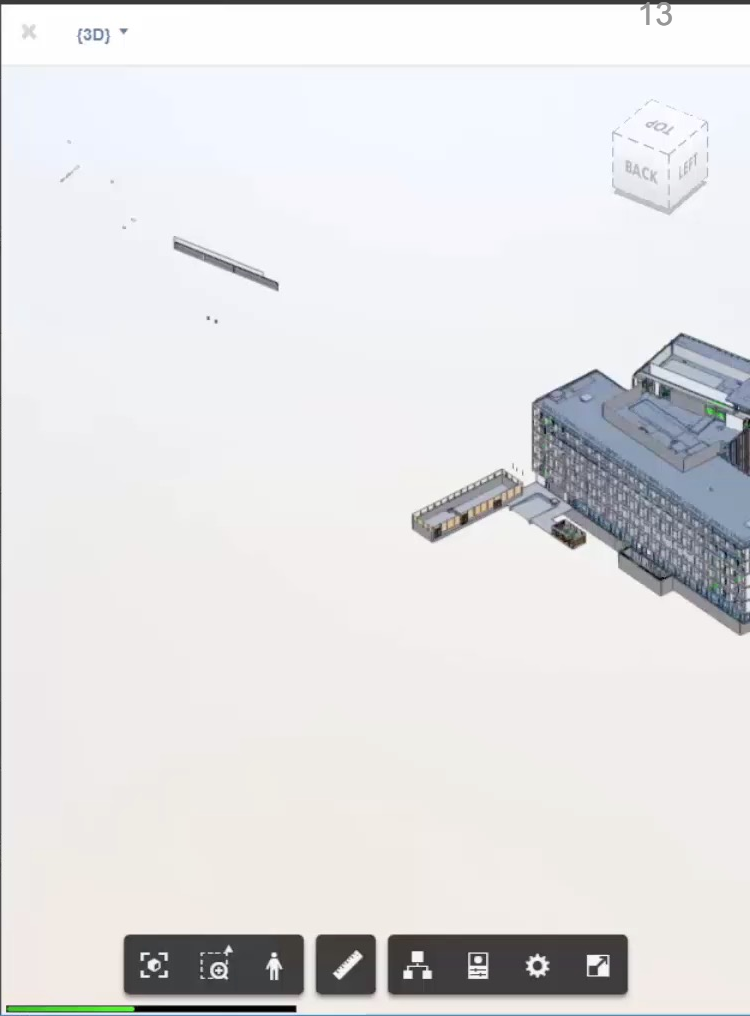
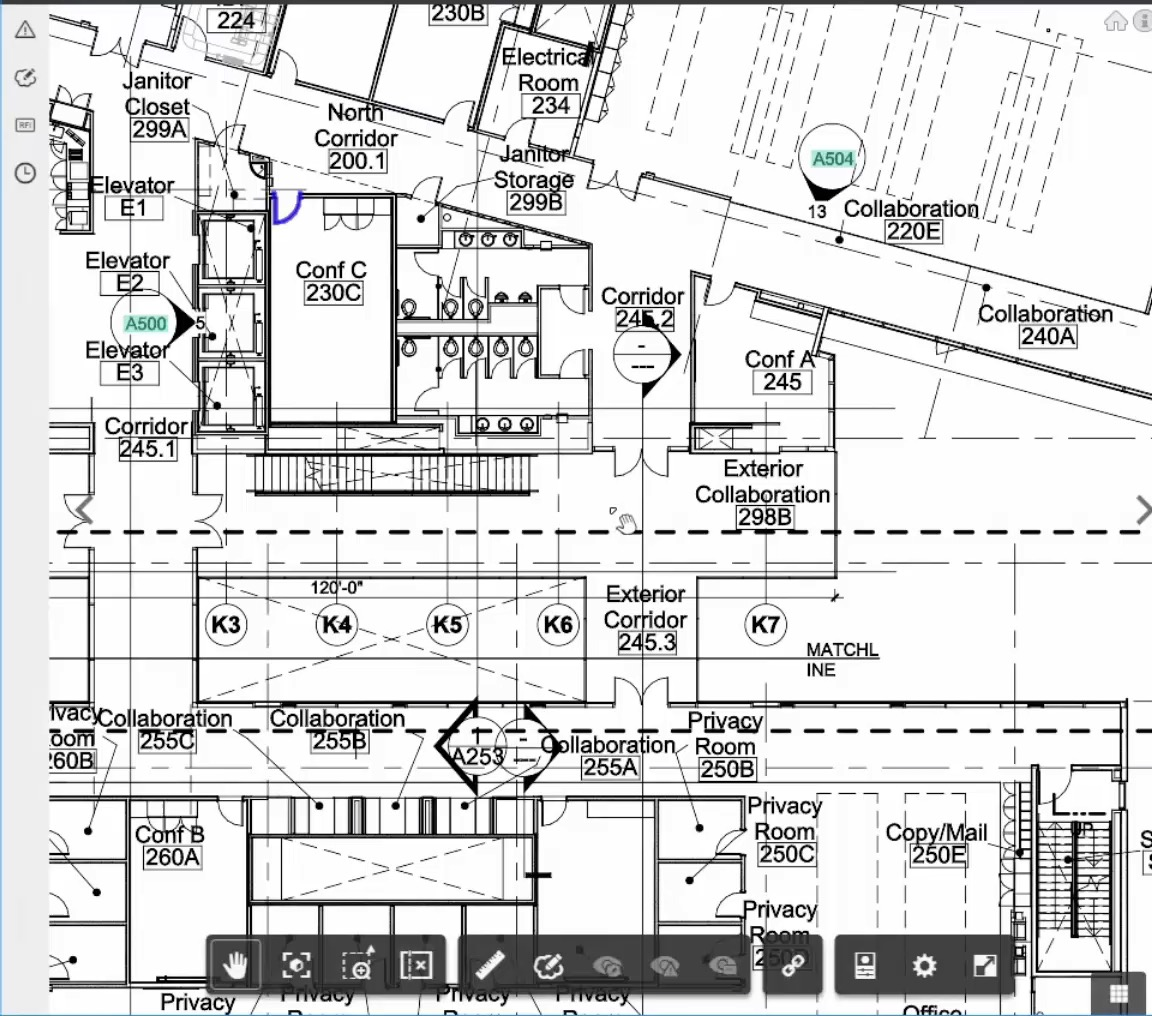



United Construction

All Business Units | All Project Types

Quality Risk Overview

33

 Active projects

- 5 High Risk Today
- 2 Medium
- 13 Low
- 13 No Data

[View Project Risk Trend](#)

Quality Risk

[View All](#)

Today

Overall

Search

Need Support

- ▲ Lumina Casino and Hotel High
- ▲ Castle Medical Center High
- ▲ Bayfront Arena High
- ▲ Market Medical Center High
- ▲ Dos Flores Resort High
- ▲ Pleasant Court Building Med

Locations

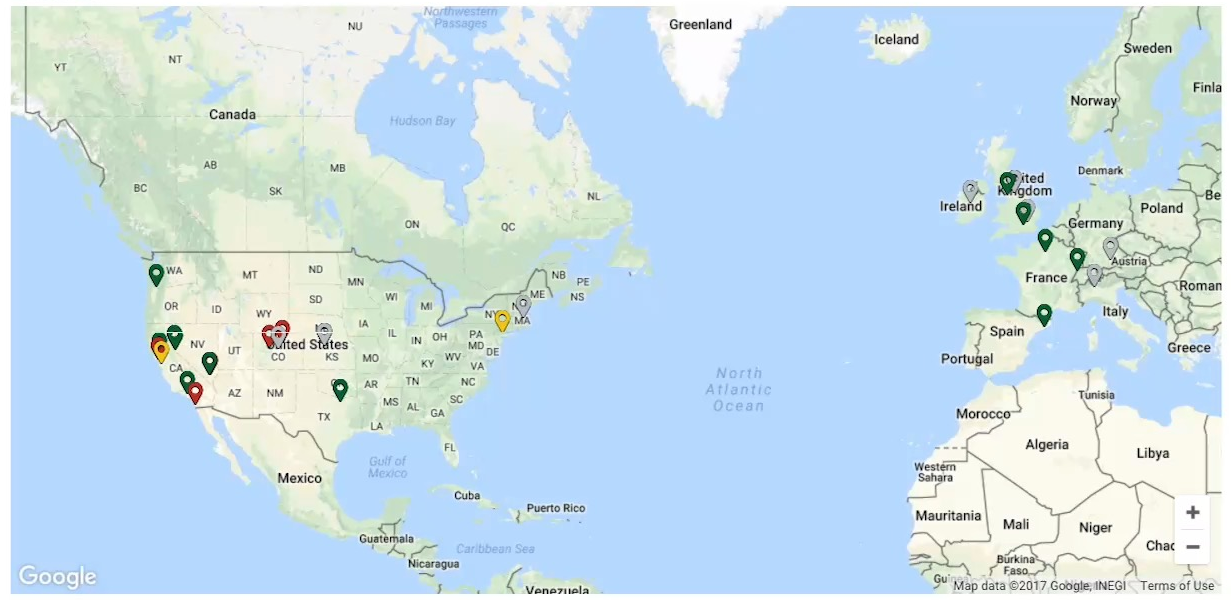

High Risk Quality Issues

- Water
- Rework
- Key Activity
- Inspection
- All

AEC PROCESS

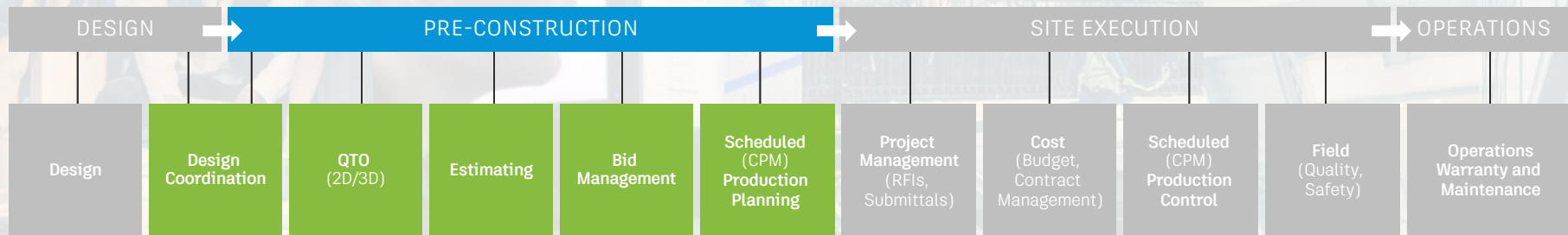

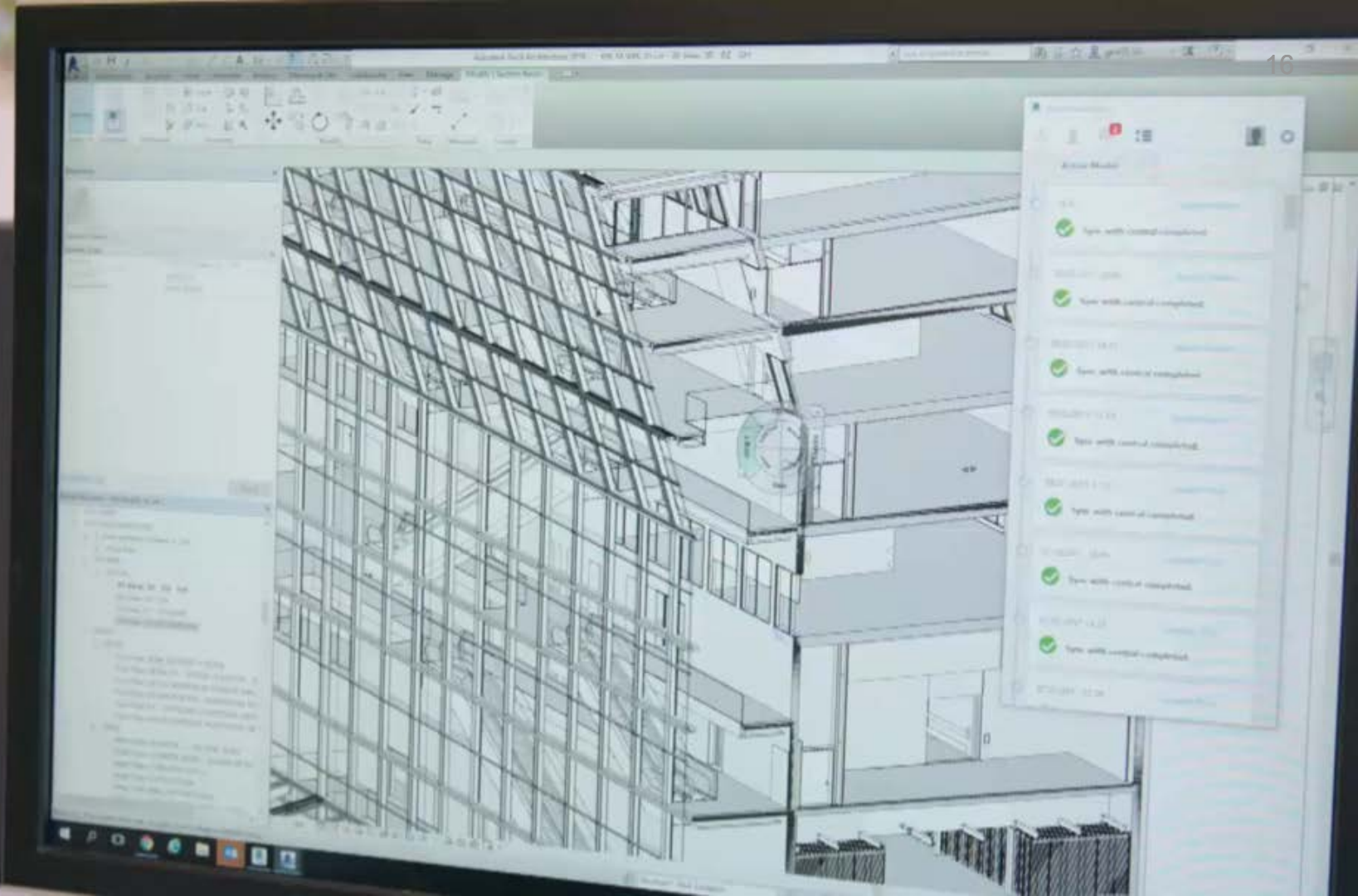



AUTODESK[®]
BIM 360[™]



AEC PROCESS

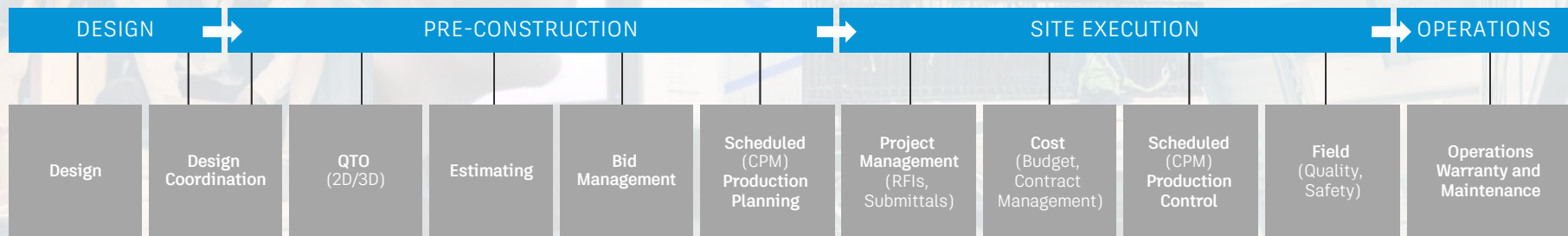

BIM DATA

Industrialized Construction



Automation
machine

Temp Min	15.56 C	Date	XXXX-XXXX	Customer	World
Temp Max	33.94 C	Time	XXXX	Status	Work
Temp Ambient	32.13 C	Job	WW25D76	Scale	MAX

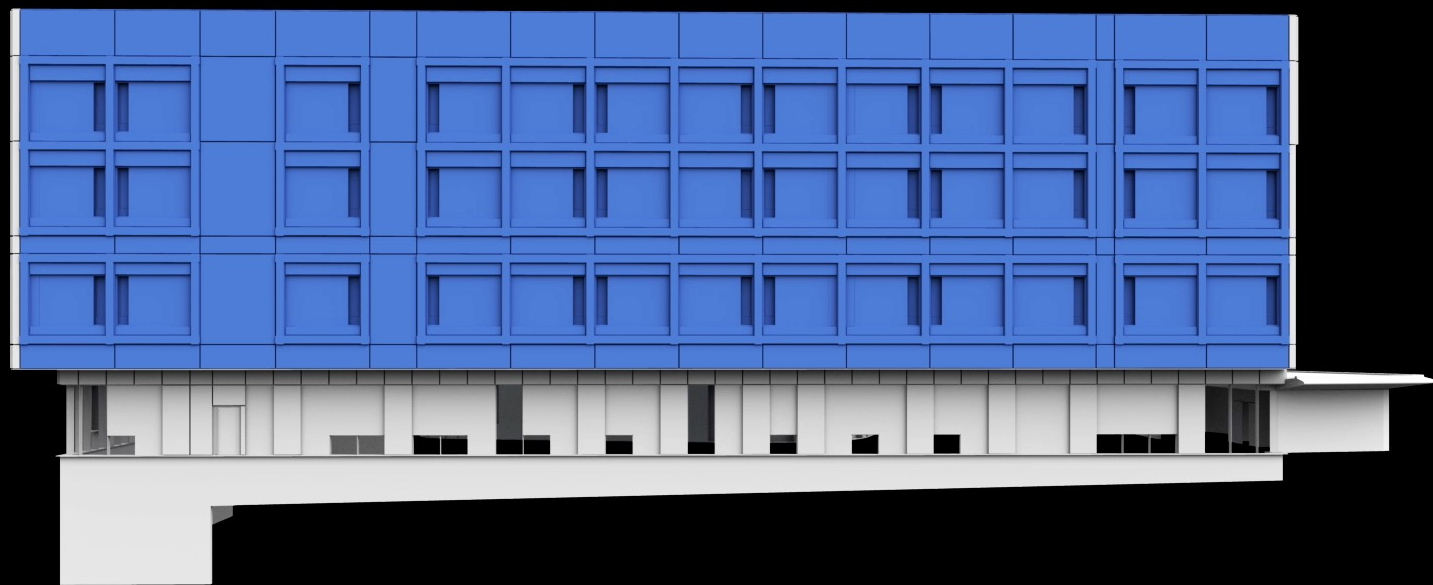

BIM DATA
AT THE CENTER

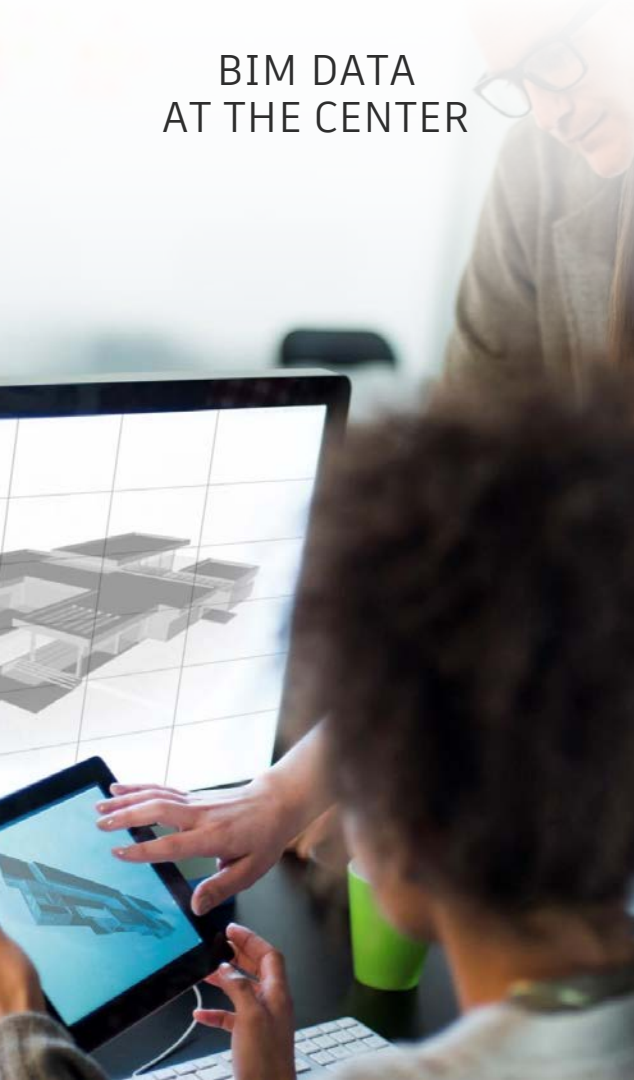

END TO END
WORKFLOW



INDUSTRIALIZED
CONSTRUCTION



Manufacturing





Significant Manufacturing Technology Investment ²⁴

Genius CAD

Microengineering Solutions

Woodbourne

Algor

Alias

COMPASS

D-Cubed

ECScad

Engineering Intent

Fatigue Wizard

iLogic

LC Design

Linius Technologies

MechSoft

Moldflow

Opticore

Plassotech

Solid Dynamics

TruE Innovations

VIA Development

Anatech

Blue Ridge

CADSoft (Eagle)

Cool Orange

Datastay

Delcam

Firehole Composites

HSMWorks

Inforbix

Lagoa

The Living

Magestic

Nei S/W

Pan

PiVR

Tsplines

VSR Systems

Within

1990s

2000–2009

2010–present





Warwick University Fusion 360 Student Users

27

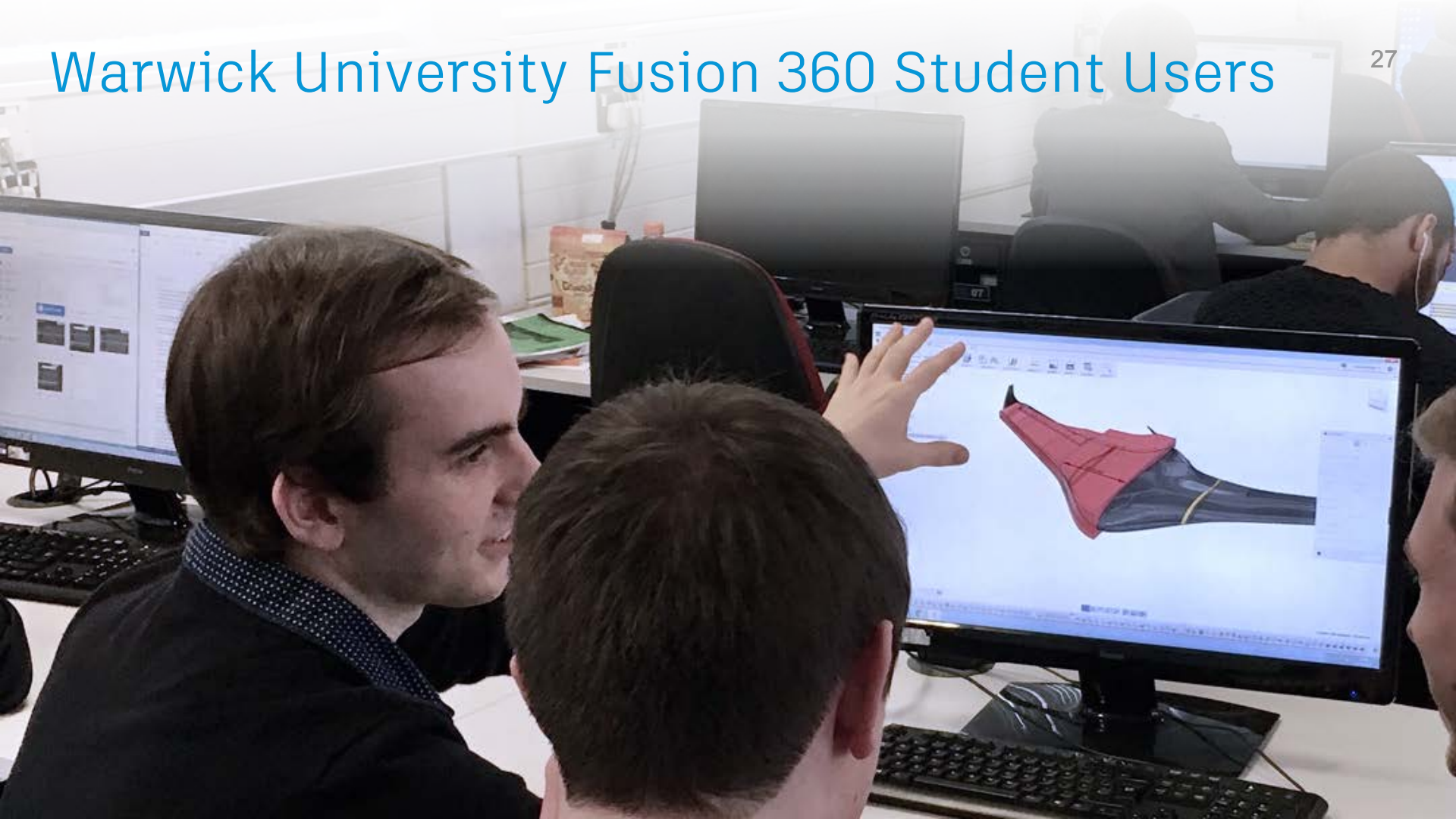



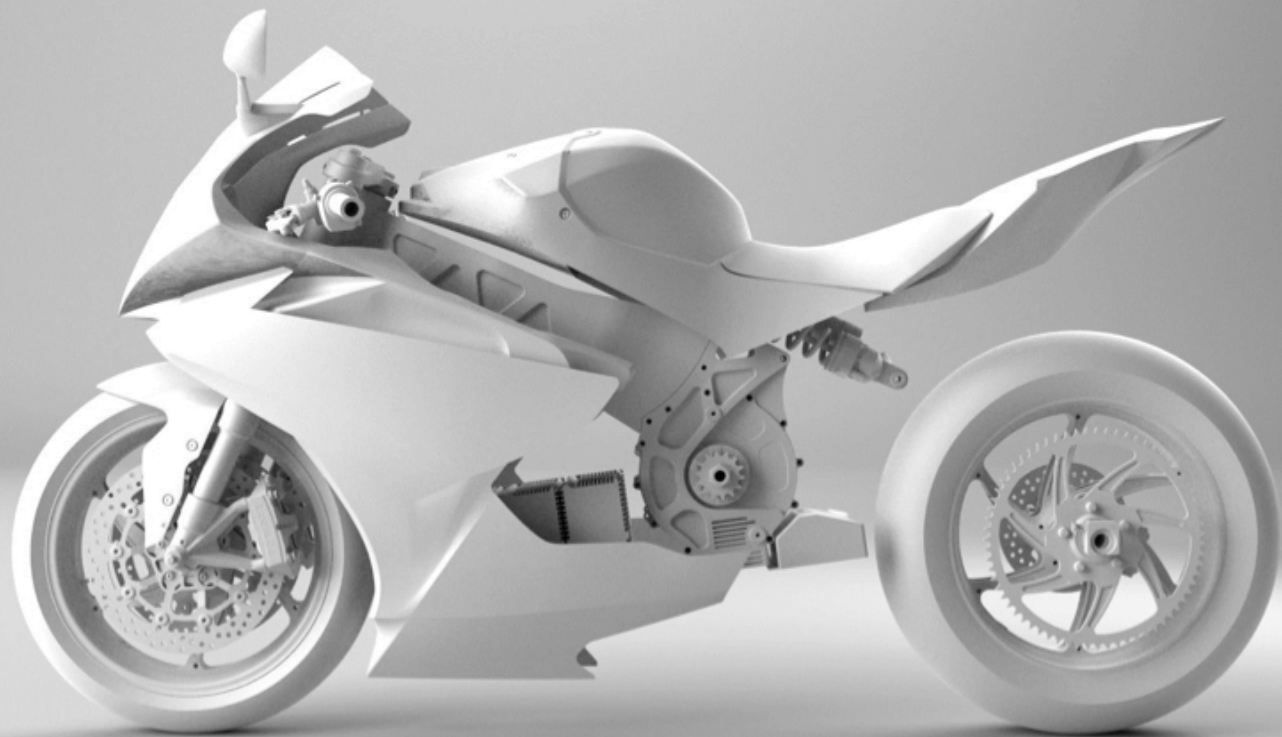

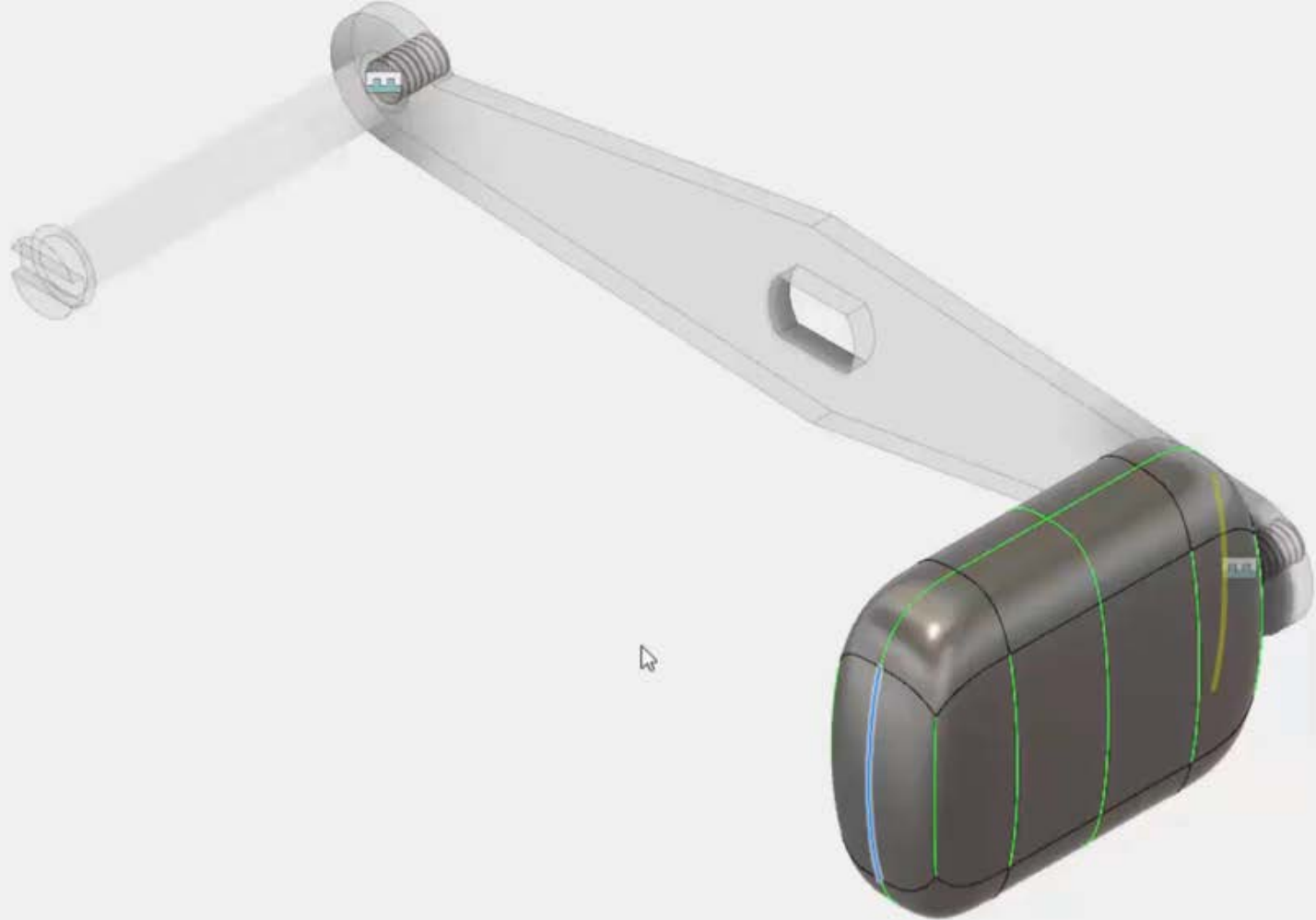

TECHNOLOGY
LEADERSHIP



REAL GENERATIVE
ALGORITHMS



CONVERGENCE OF ³¹
DESIGN & MANUFACTURING





AUTODESK[®]
FORGE



**AUTODESK®
FUSION 360™**



**AUTODESK®
BIM 360™**





AUTODESK[®]
FORGE

Project NECA 2017 Model NECA 2017

Filters: Areas (On)

- All Areas
 - Unassigned Parts
 - Level 1 (405)
 - Area A
 - Area B
 - Level 2 (4)
 - Area A
 - Area B

GRID OFFSET

Part Anchor - DEWALT - 07540-PWR

Point: X: -14' 4-3/8" Y: -7' 5-3/8" Z: 10' 0"

B3: 2' 10-1/2" N (B) 4' 2-1/16" E (3)

PROPERTIES

Family and Type	Anchor - DEWALT - 07540-PWR
GTP_UnitedParam_0	GTP_PointNumber_1
GTP_PointElement_0	
GTP_PointNumber_0	
GTP_PointRole_0	
Hanger Assembly ID	Anchor 2
Host	None
Host Id	-1
Interaction DCR	0

“Web development was a new endeavor for us. Autodesk Forge helped us get STRATUS off the ground in a way that saved time and was cost effective—which allowed a small company like ours to do big things.”

—Todd Liebke, President, GTP Services

Variable ▾

Color By : Velocity ▾

Colours : 2 Colours : 77

Selected Only

Opacity : 0.2 Opacity : 1

Settings ▾

Flow animation speed :

Speed : 30 Speed : 100

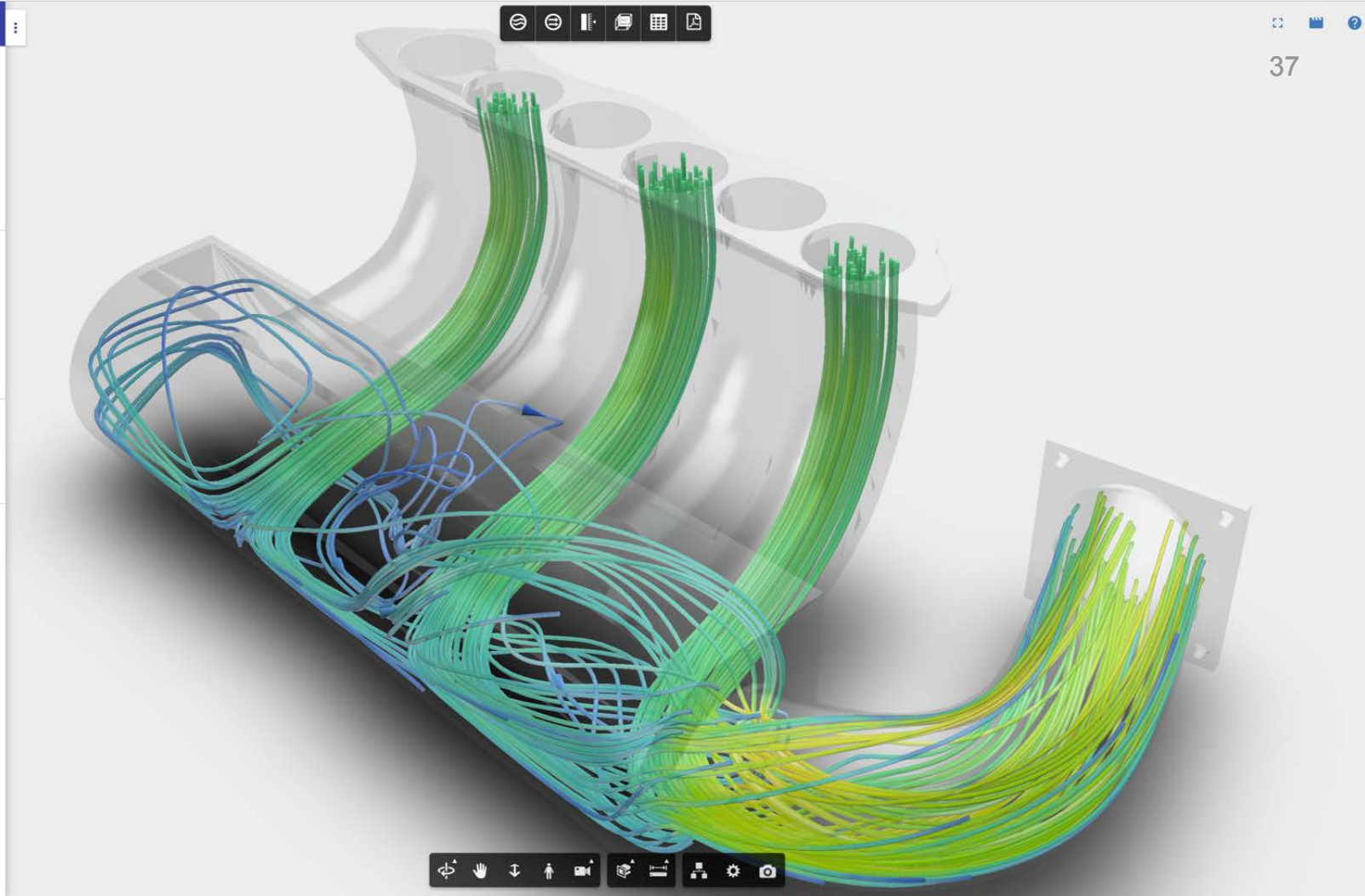



8K DEVELOPERS

BIM DATA
AT THE CENTER

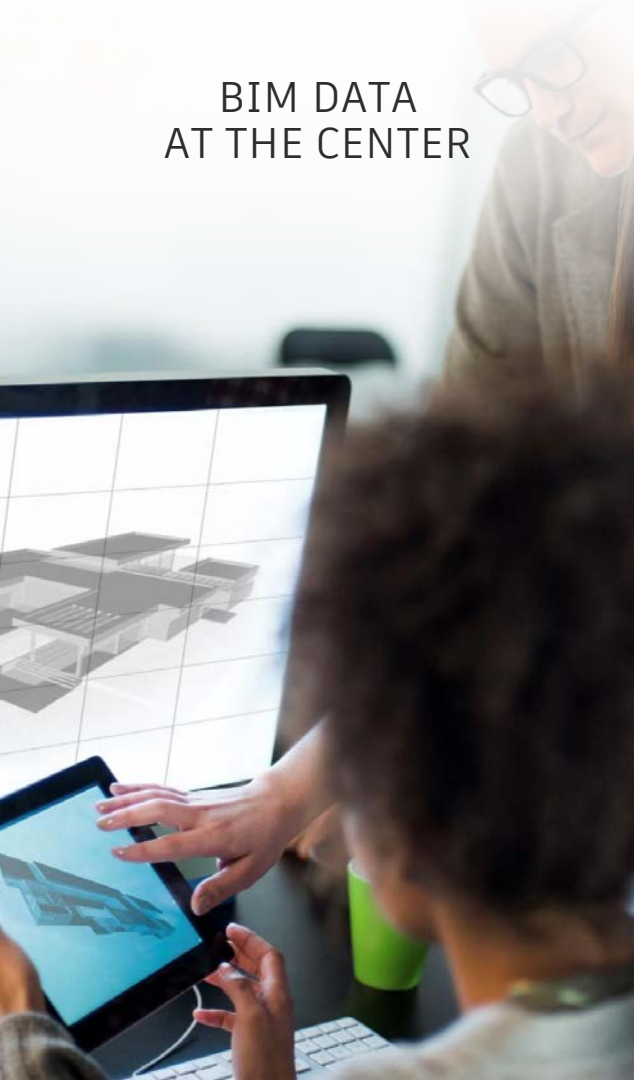

CONVERGENCE OF DESIGN
& MANUFACTURING



COMMON
CLOUD PLATFORM



